

CASA SANTO ANTÔNIO
Santo Antônio do Pinhal, SP | 2011-2014

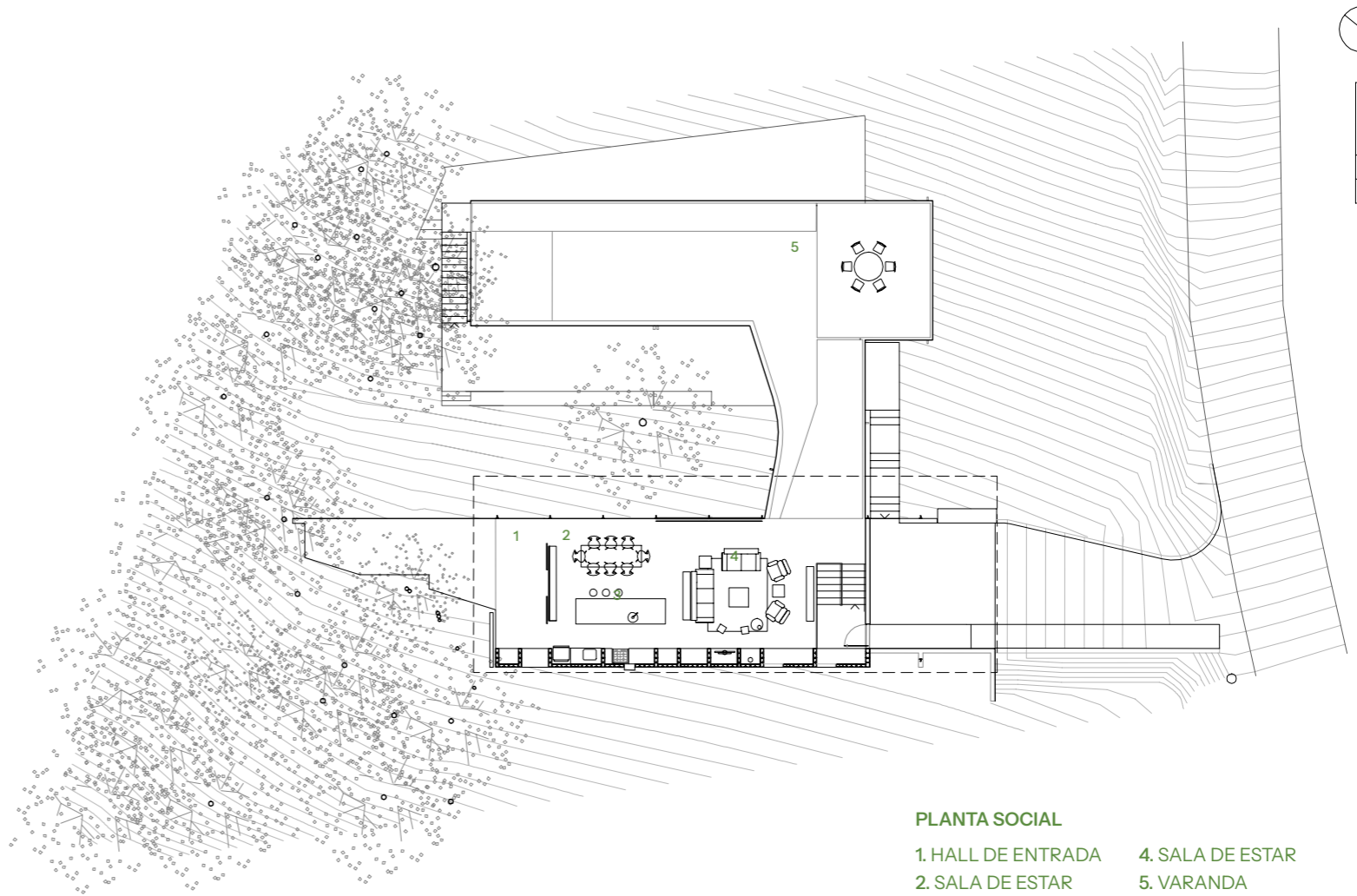

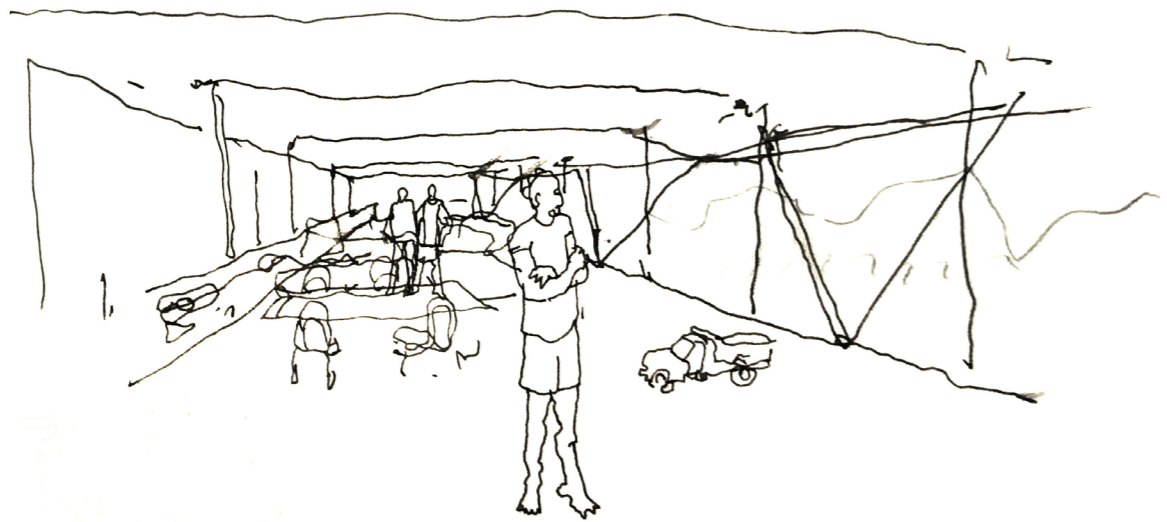

fotos: Pedro Napolitano

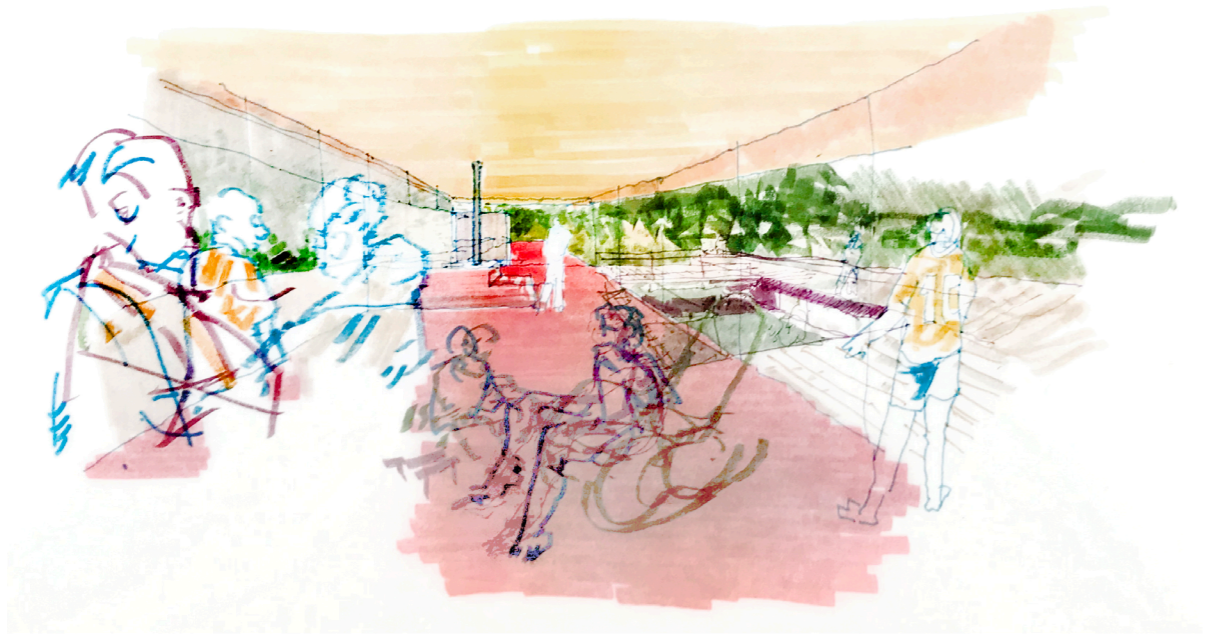

PLANTA SOCIAL

- 1. HALL DE ENTRADA
- 2. SALA DE ESTAR
- 3. COZINHA
- 4. SALA DE ESTAR
- 5. VARANDA

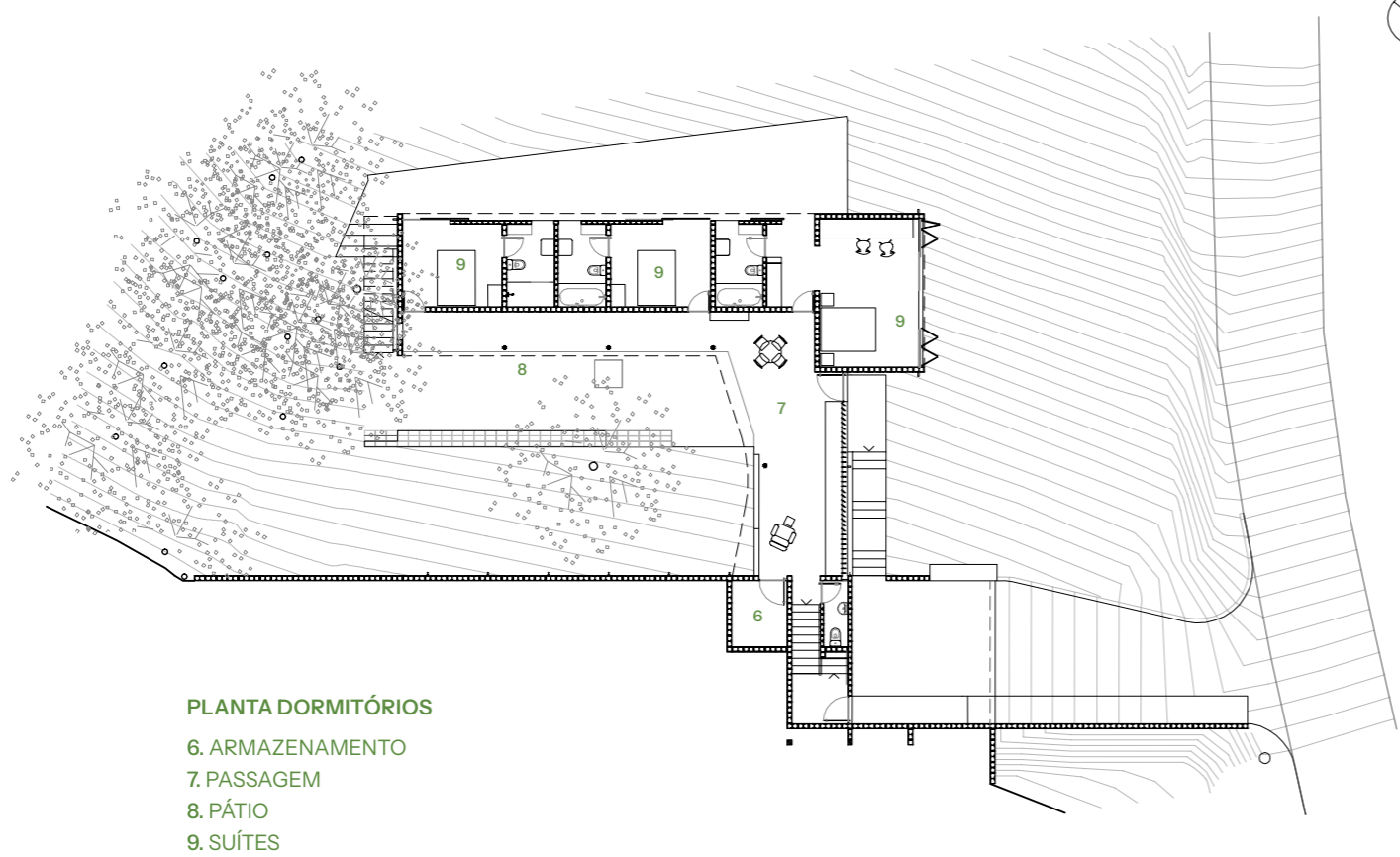

PLANTA DORMITÓRIOS

- 6. ARMAZENAMENTO
- 7. PASSAGEM
- 8. PÁTIO
- 9. SUÍTES

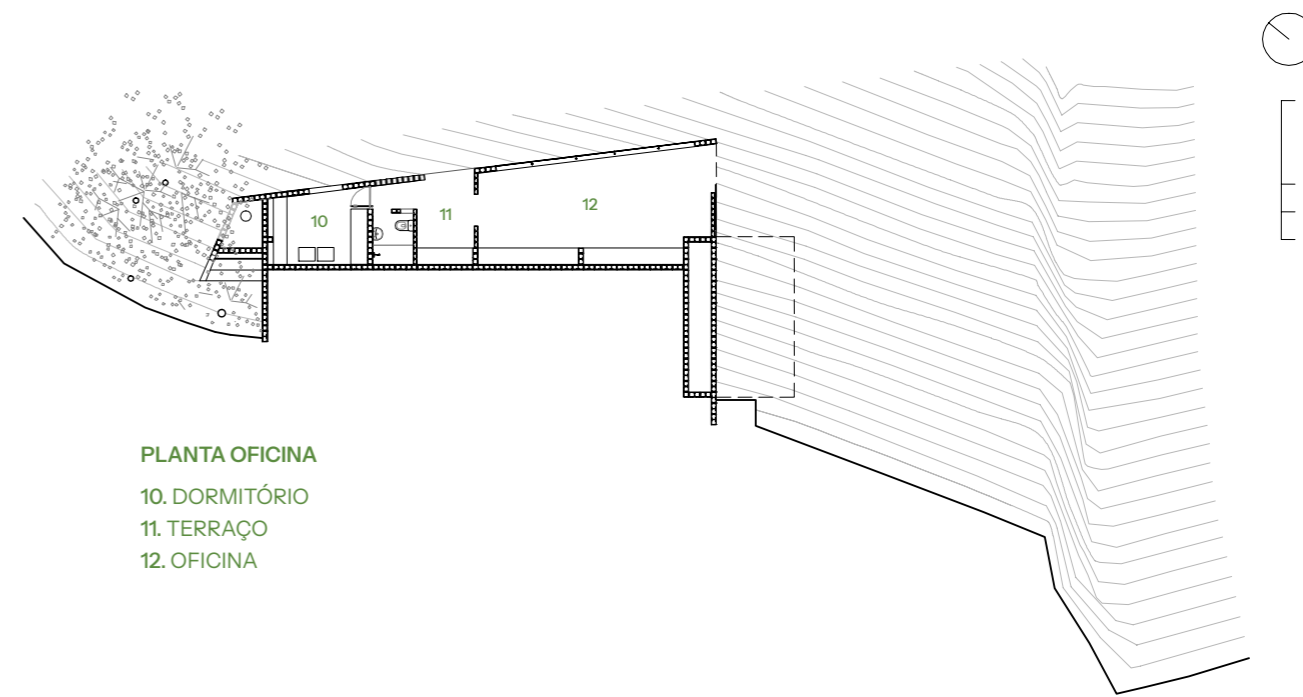

PLANTA OFICINA

- 10. DORMITÓRIO
- 11. TERRAÇO
- 12. OFICINA



fotos: Pedro Napolitano